

ASCUTNEY INSET 1  
SCALE 1:6336  
0 0.125 0.25 Miles  
SCALE FOR INSETS (UNLESS OTHERWISE NOTED)

- HIGHWAYS**
- INTERSTATE
- U.S. ROUTE
- STATE ROUTE
- CLASS 1
- CLASS 2
- CLASS 3
- CLASS 4
- INTERSTATE OR DIVIDED HIGHWAY
- STATE - HARD SURFACE OR PAVED
- TOWN - HARD SURFACE OR PAVED
- GRAVEL
- SOIL OR GRADED AND DRAINED EARTH
- UNIMPROVED OR PRIMITIVE
- IMPASSABLE OR UNTRAVELED
- LEGAL TRAIL
- DISCONTINUED
- HIGHWAY CLASS CHANGE
- RAILROAD
- PUBLIC LAND
- POLITICAL SUBDIVISIONS
- STATE BOUNDARY
- COUNTY BOUNDARY
- TOWN BOUNDARY
- VILLAGE BOUNDARY
- URBAN COMPACT BOUNDARY
- WATER BODIES
- OPEN WATER
- SWAMP
- STREAM OR BROOK
- BRIDGE OR CULVERT
- BRIDGE OR CULVERT GREATER THAN 20'
- BRIDGE OR CULVERT 6' - 20'
- B34 STATE BRIDGE IDENTIFIER
- TOWN BRIDGE IDENTIFIER
- FEDERAL CLASSIFICATION IDENTIFIER
- FAU URBAN ARTERIAL OR COLLECTOR
- MA MINOR ARTERIAL
- MJC MAJOR COLLECTOR
- MNC MINOR COLLECTOR
- PA PRINCIPAL ARTERIAL

VERMONT  
GENERAL HIGHWAY MAP  
**Town of Weathersfield**  
WINDSOR COUNTY  
Transportation District #2

Prepared by the  
Vermont Agency of Transportation  
Policy & Planning Division  
in cooperation with  
U.S. Department of Transportation  
Federal Highway Administration

Mileage as of: Feb. 10, 2005  
Map generated: December, 2005

SCALE: 1:31680

0.5 0 0.5 1 1.5 2 2.5 Miles  
1 0.5 0 1 2 3 Kilometers

TOWN HWY. NO.	LENGTH IN MILES CLASS 3	CLASS 4		
5	1.460		55	0.120
6	0.900		56	0.070
7	0.490		57	0.700
8	1.830		58	0.570
9	1.690		61	1.710
10	0.450		62	1.700
11	0.650		63	0.220 (0.080)
12	0.260		64	0.690
13		(0.300)	65	0.300
14	0.130		66	0.610 (1.300)
15	0.230		67	
16	0.290	(0.160)	68	0.050
17	0.050		69	0.210
18	0.480		70	0.100
19	0.200	(0.100)	71	0.380
20	1.940		72	0.400
21	1.180		73	0.090
22		(0.220)	74	0.300
23	0.050		75	0.150
24	0.100		77	0.220
25	0.630		78	0.180
26	1.350		79	0.300 (0.370)
28	0.950		80	0.050 (0.100)
29	0.550		81	0.760 (0.270)
30	0.680		82	0.190
31	1.520		83	0.190
32	0.900		84	0.420 (0.060)
33	0.090		85	0.370
34	0.440		86	0.460
35	0.150		87	0.310
36	0.300		88	1.120
37	2.260		89	0.150
38	0.080		90	0.360
39	0.270		91	
40	0.620		93	0.070 (0.060)
41	0.280		94	0.150
42	0.760		95	
43		(0.450)	96	0.380 (0.250)
44	2.290		97	0.080
45	0.700		98	0.170
46	3.370		99	0.150 (0.080)
47	0.950		101	
48	0.580		102	0.030
49	0.400		103	0.200
50	2.670	(0.300)	104	0.230
51	2.720		106	0.230
52	0.820	(0.100)	107	0.140
53		(0.080)	108	0.300
54	1.080	(0.150)	109	0.450
<b>TOTAL</b>			<b>54.940</b>	<b>4.430</b>

• Portion of this town highway is Class 3, but is functionally Class 4

**MILEAGE SUMMARY**

CLASS	TH	MILEAGE	TOTAL CLASS
CLASS 2			
	TH-1	5.250	
	TH-3	0.480	
	TH-4	5.970	
	TH-5	1.200	
	TH-6	1.280	
	<b>TOTAL CLASS 2</b>	<b>14.180</b>	
CLASS 3			
	<b>TOTAL CLASS 3</b>	<b>54.940</b>	
	<b>TOTAL TOWN</b>	<b>69.120</b>	
STATE HIGHWAY			
	VT-12	0.394	
	VT-44A	0.501	
	VT-106	7.226	
	VT-131	8.647	
	<b>TOTAL STATE HIGHWAY</b>	<b>16.768</b>	
US HIGHWAY			
	US-5	6.791	
	<b>TOTAL US HIGHWAY</b>	<b>6.791</b>	
	<b>TOTAL STATE</b>	<b>23.559</b>	
INTERSTATE			
	I-91	6.624	
	<b>TOTAL INTERSTATE</b>	<b>6.624</b>	
INTERSTATE - Ramp			
	I-91	0.863	
	<b>TOTAL INTERSTATE - Ramp</b>	<b>0.863</b>	
	<b>TOTAL INTERSTATE</b>	<b>7.487</b>	

**TOTAL, TRAVELED HIGHWAYS, FEB. 10, 2005: 100.166**  
(Excludes Class 4 Mileage)

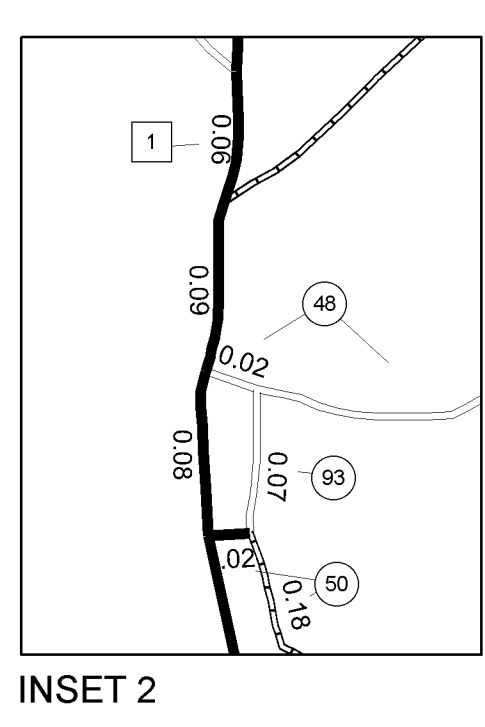

INSET 2

**DISCLAIMER:**  
Highway and bridge data by the Agency of Transportation, Policy & Planning Division. All other data from the Vermont Center for Geographic Information.

