

TOWN HWY NO.	LENGTH IN MILES	CLASS
6	0.830	4
7	5.320	
8	0.090	
9	0.450	
10	1.530	
11	0.080	(0.720)
12	0.090	
13	0.040	
14	1.020	
15	0.260	
16	0.530	
17	0.240	
18	2.570	
19	1.300	(0.700)
20	0.460	
21	0.560	
22	1.570	(0.390)
23	0.230	
24	0.290	
25	0.320	(0.330)
26	0.450	
27	0.180	
28	0.580	
29	3.550	
30	0.580	
31	0.300	
32	1.030	
33	0.120	(0.480)
34	0.340	
35	0.160	
36	0.230	
37	4.810	
38	0.160	
39	0.130	(0.060)
40	0.710	(0.080)
41	0.240	(0.080)
42	0.290	
43	0.370	
44	0.070	(0.140)
45	0.070	
46	0.240	
47	0.110	
48	0.280	
49	0.300	
50	0.560	
51	0.420	
52	1.490	
53	0.110	
54	1.210	
55	0.650	
56	0.390	
57	0.390	
58	0.130	
59	0.450	
60	0.080	
61	0.320	
62	0.780	(0.180)
63	0.110	
64	1.620	
65	0.060	
66	0.860	
67	0.000	(0.300)
68	0.250	
69	0.300	
70	0.110	
71	0.060	
72	0.260	
73	0.370	
74	0.150	
75	0.520	
76	0.260	
77	0.370	
78	0.150	
79	0.520	
80	0.260	
81	0.260	
TOTAL	49.290	3.460

- HIGHWAYS**
- INTERSTATE
 - STATE HIGHWAY SYSTEM
 - TOWN HIGHWAY SYSTEM
 - U - IMPASSABLE OR UNTRAVELED
 - D - DISCONTINUED
 - LT - LEGAL TRAIL
 - FT - FOOT TRAIL

- 88 INTERSTATE ROUTE
- 2 U.S. NUMBERED ROUTE
- 3 STATE NUMBERED ROUTE
- 7 INTERCHANGE NUMBER
- 4 CLASS 1 TOWN HIGHWAY
- 2 CLASS 2 TOWN HIGHWAY
- 6 CLASS 3 TOWN HIGHWAY
- 6 CLASS 4 TOWN HIGHWAY
- NFR NATIONAL FOREST ROAD
- SFH STATE FOREST HIGHWAY

- BRIDGE OR CULVERT < 6'
- BRIDGE OR CULVERT 6' - 20'
- BRIDGE GREATER THAN 20'
- COVERED BRIDGE

- ROAD SURFACE TYPES**
- STATE PAVED
 - OTHER PAVED
 - STATE GRAVEL
 - OTHER GRAVEL
 - GRADED AND DRAINED
 - UNIMPROVED/PRIMITIVE

- NATURAL FEATURES**
- SINGLE LINE STREAM
 - OPEN WATER
 - SWAMP

- POLITICAL SUBDIVISIONS**
- STATE BOUNDARY
 - COUNTY BOUNDARY
 - TOWN BOUNDARY
 - CITY BOUNDARY
 - VILLAGE BOUNDARY
 - URBAN COMPACT BOUNDARY

- OTHER TRANSPORTATION**
- RAILROAD
 - AIRPORT TERMINAL

- MISCELLANEOUS**
- DAM

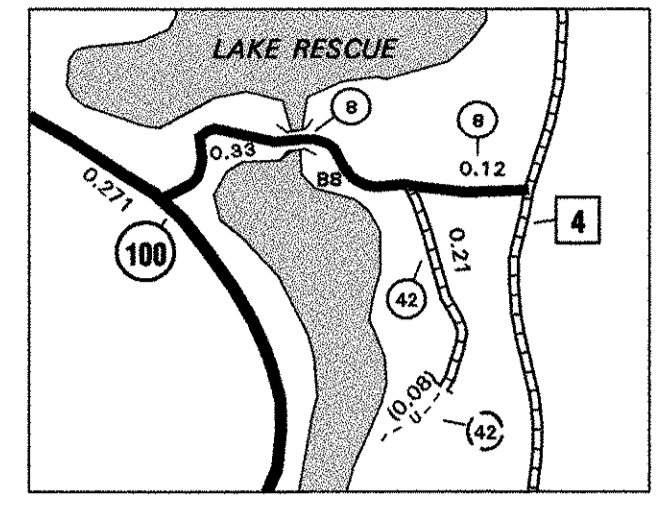
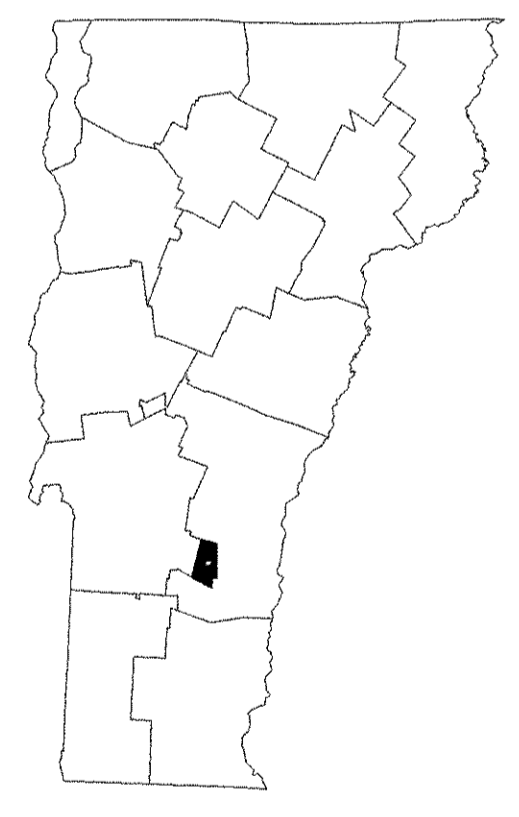

LAKE RESCUE INSET 1

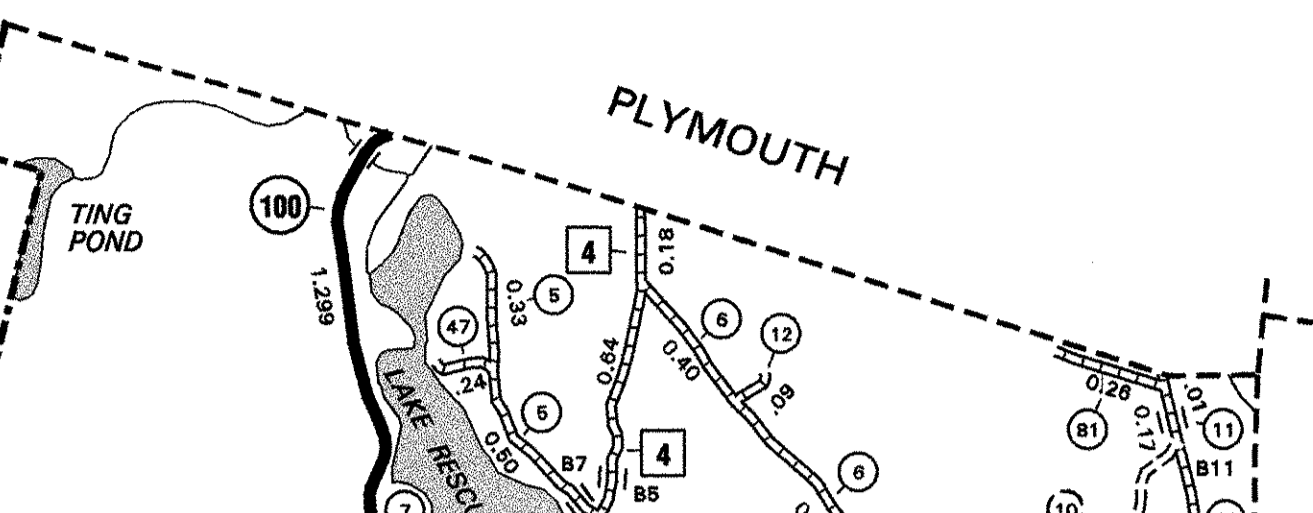

LAKE RESCUE INSET 2

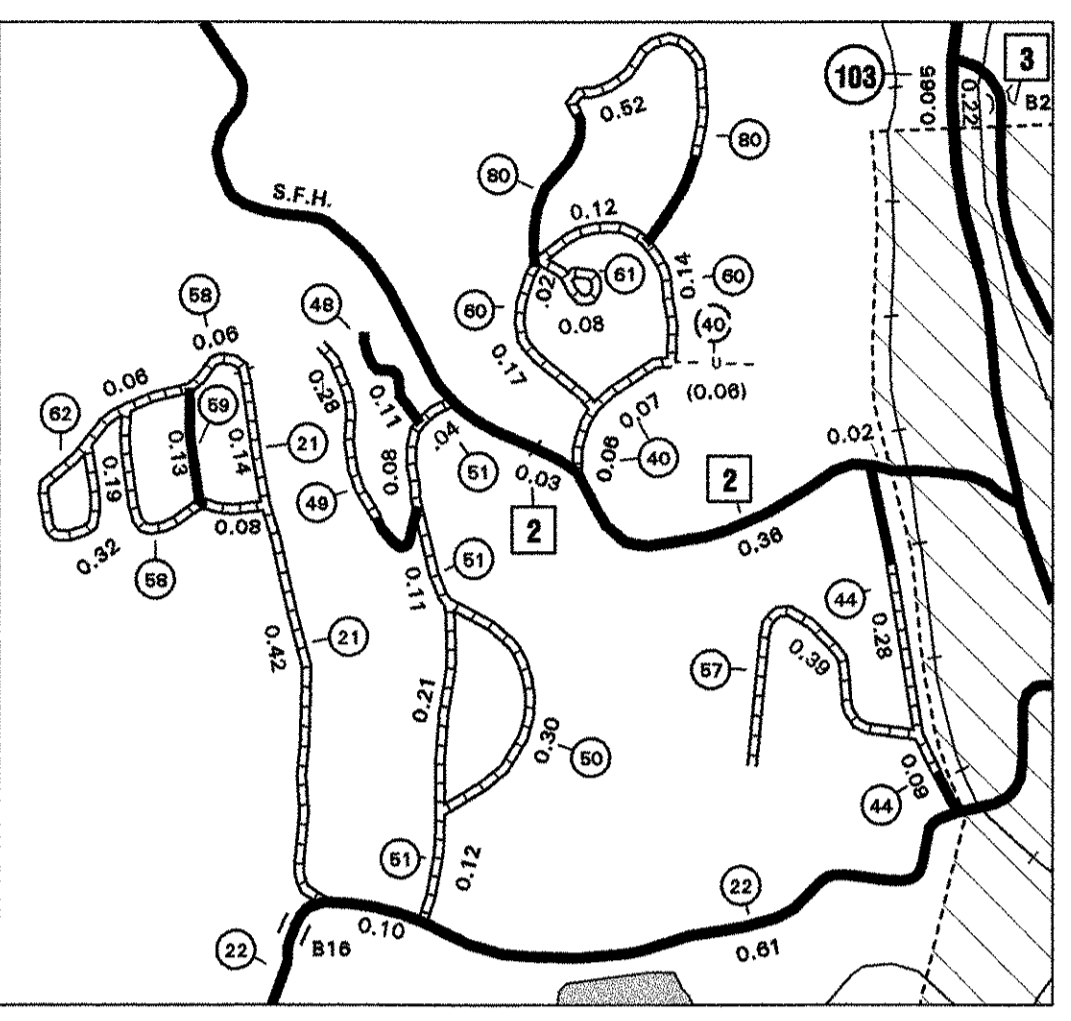

SMITHVILLE INSET 2

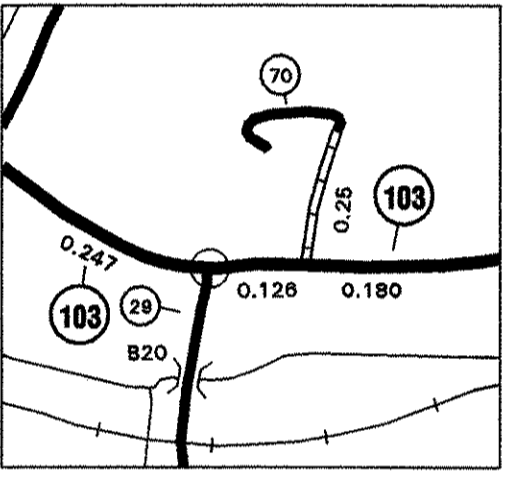

SMITHVILLE INSET 1

* PORTION(S) OF THESE TOWN HIGHWAYS ARE CLASS 3, BUT ARE FUNCTIONALLY CLASS 4.

MILEAGE SUMMARY

CLASS 1 TOWN HIGHWAYS:		
TOTAL CLASS 1 TOWN HWYS.	0.000	
CLASS 2 TOWN HIGHWAYS:		
NO. 1	1.100	
NO. 2	0.410	
NO. 3	0.220	
NO. 4	2.360	
TOTAL CLASS 2 TOWN HWYS.	4.090	
CLASS 3 TOWN HIGHWAYS:		
TOTAL CLASS 3 TOWN HWYS.	49.290	53.380
TOTAL TOWN HWYS.		
STATE HIGHWAYS:		
INTERSTATE RAMPS	0.000	
TOTAL INTERSTATE HWYS.	0.000	
STATE HWY. 100	7.748	
STATE HWY. 103	4.069	
TOTAL NON-INTERSTATE HWYS.	11.817	11.817
TOTAL STATE HWYS.		
TOTAL TRAVELLED HWYS., FEB. 10, 2003 (EXCLUDES CLASS 4 MILEAGE)	65.197	

DISCLAIMER: Highway and bridge data by Vermont Agency of Transportation, Division of Program Development. All other data from Vermont Center for Geographic Information.

VERMONT GENERAL HIGHWAY MAP TOWN OF LUDLOW

PREPARED BY THE VERMONT AGENCY OF TRANSPORTATION PROGRAM DEVELOPMENT DIVISION IN COOPERATION WITH U.S. DEPARTMENT OF TRANSPORTATION FEDERAL HIGHWAY ADMINISTRATION

