

TOWN NO.	LENGTH IN MILES CLASS 3	LENGTH IN MILES CLASS 4					
9	3.700		49	0.280	91	0.110	
10	5.410		50	0.060	92	0.070	
11	0.360		51	0.070	93	0.250	
12	0.970		52	0.970	94	0.210	
13	0.280		52	(0.180)	95	0.140	
14	0.250	(2.310)	53	0.400	97	0.220	
15	1.000	(0.300)	54	0.500	98	0.020	
16	0.470	(0.300)	55	0.510	99	0.100	
17	0.880		56	0.400	100	0.450	
18	0.180		57	0.600	(0.530)	101	0.440
19	1.080		58	1.660	(0.440)	102	0.060
20	2.000	(0.200)	59	1.860		103	0.110
21	0.570	(0.850)	60	0.610	(0.190)	104	0.150
22	1.770		61	0.800		105	0.210
23	0.630		62	0.280		106	0.350
24	0.710		63	2.240	(0.080)	107	0.700
25	0.160		63	(0.460)		108	0.310
26	0.070		64	0.100		109	0.160
27	0.750		65	0.110		110	0.340
28	0.250		66	1.350		111	0.070
29	0.300		67	0.070		112	0.730
30	2.300		68	1.210	(0.290)	113	0.350
31	0.350		69	0.090		114	0.420
32	0.900		70	0.560		115	0.110
33	4.720		71	1.020		116	0.040
34	0.080		72	0.480		117	0.150
34	(0.370)		73	0.220		118	0.050
35	(0.340)		74	0.080		119	0.060
36	0.390		75	0.200		120	0.370
37	0.600		76	0.120		121	0.090
38	1.950		77	0.040		122	0.540
39	0.220		78	0.120		123	0.140
40	1.010		79	0.050		125	0.170
41	0.300		80	0.080		126	0.910
42	3.920		81	0.890		127	0.160
43	3.180		82	0.300		128	0.160
44	0.200		83	(0.070)		129	0.230
45	0.300		84	1.240		130	0.150
45	(0.500)		85	0.060		131	0.150
46	0.500		86	0.130		132	0.160
47	1.900		87	0.560			
48	0.600		90	0.110		TOTAL	75.250 7.110

* Portion of this town highway is Class 3, but is functionally Class 4

MILEAGE SUMMARY

CLASS	LENGTH	TOTAL
CLASS 1		2.500
TH-1	1.667	
TH-2	0.833	
CLASS 2		12.609
TH-3	2.610	
TH-4	0.189	
TH-5	0.950	
TH-6	3.190	
TH-7	1.480	
TH-8	0.100	
TH-9	4.090	
CLASS 3		75.250
STATE HIGHWAY		19.107
VT-10	3.540	
VT-11	7.504	
VT-103	8.063	
TOTAL STATE HIGHWAY		19.107
TOTAL TOWN		90.359

TOTAL, TRAVELED HIGHWAYS, FEB. 10, 2005: 109.466
(Excludes Class 4 Mileage)

- HIGHWAYS**
- INTERSTATE
- U.S. ROUTE
- STATE ROUTE
- CLASS 1
- CLASS 2
- CLASS 3
- CLASS 4
- STATE - HARD SURFACE OR PAVED
- TOWN - HARD SURFACE OR PAVED
- GRAVEL
- SOIL OR GRADED AND DRAINED EARTH
- UNIMPROVED OR PRIMITIVE
- IMPASSABLE OR UNTRAVELED
- LEGAL TRAIL
- DISCONTINUED
- HIGHWAY CLASS CHANGE
- RAILROAD
- PUBLIC LAND
- POLITICAL SUBDIVISIONS
- STATE BOUNDARY
- COUNTY BOUNDARY
- TOWN BOUNDARY
- VILLAGE BOUNDARY
- URBAN COMPACT BOUNDARY
- WATER BODIES
- OPEN WATER
- SWAMP
- STREAM OR BROOK
- BRIDGE OR CULVERT
- BRIDGE OR CULVERT GREATER THAN 20'
- BRIDGE OR CULVERT 6' - 20'
- B34 STATE BRIDGE IDENTIFIER
- B34 TOWN BRIDGE IDENTIFIER
- FEDERAL CLASSIFICATION IDENTIFIER
- FAU URBAN ARTERIAL OR COLLECTOR
- MA MINOR ARTERIAL
- MJC MAJOR COLLECTOR
- MNC MINOR COLLECTOR
- PA PRINCIPAL ARTERIAL

DISCLAIMER:
Highway and bridge data by the Agency of Transportation, Policy & Planning Division. All other data from the Vermont Center for Geographic Information.

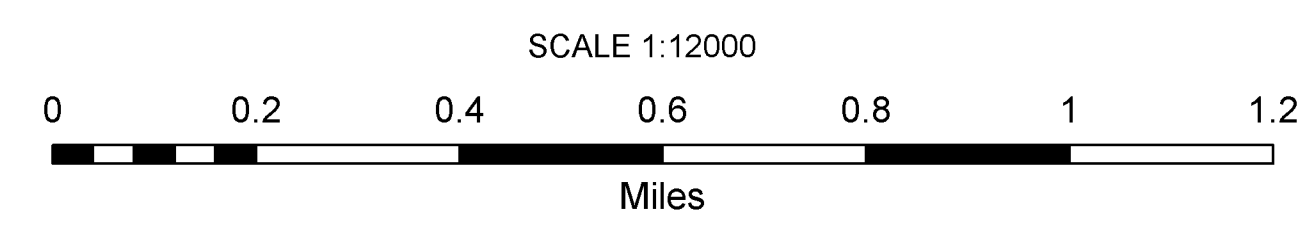
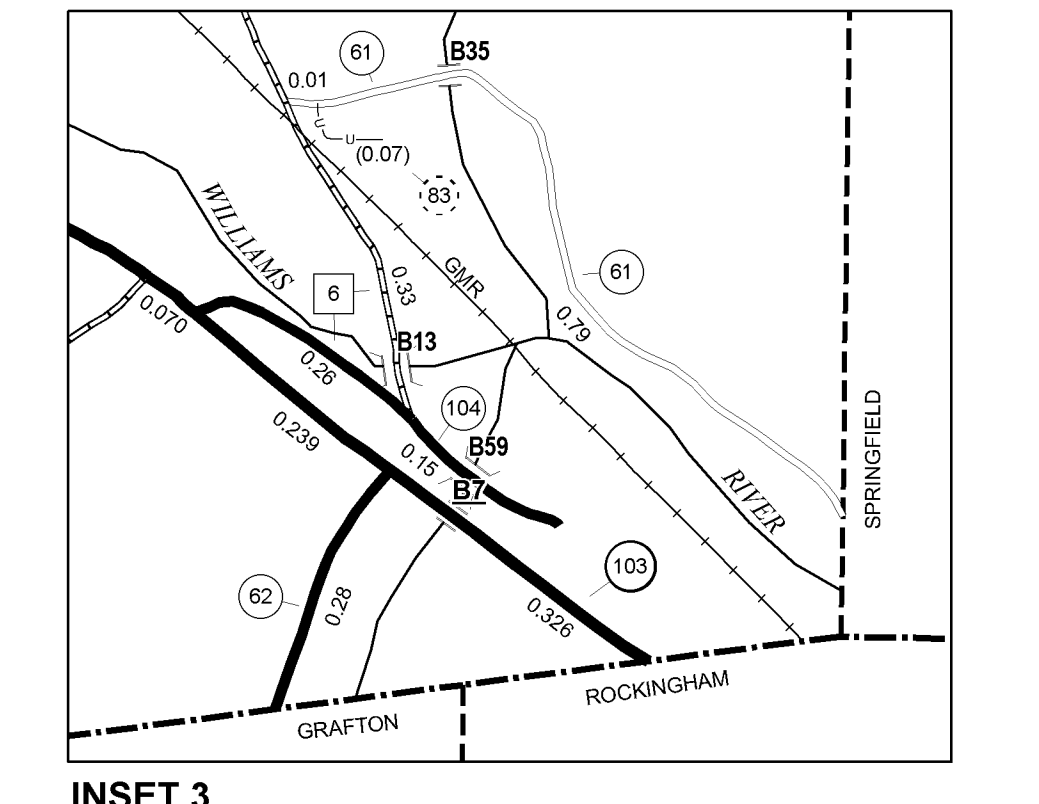
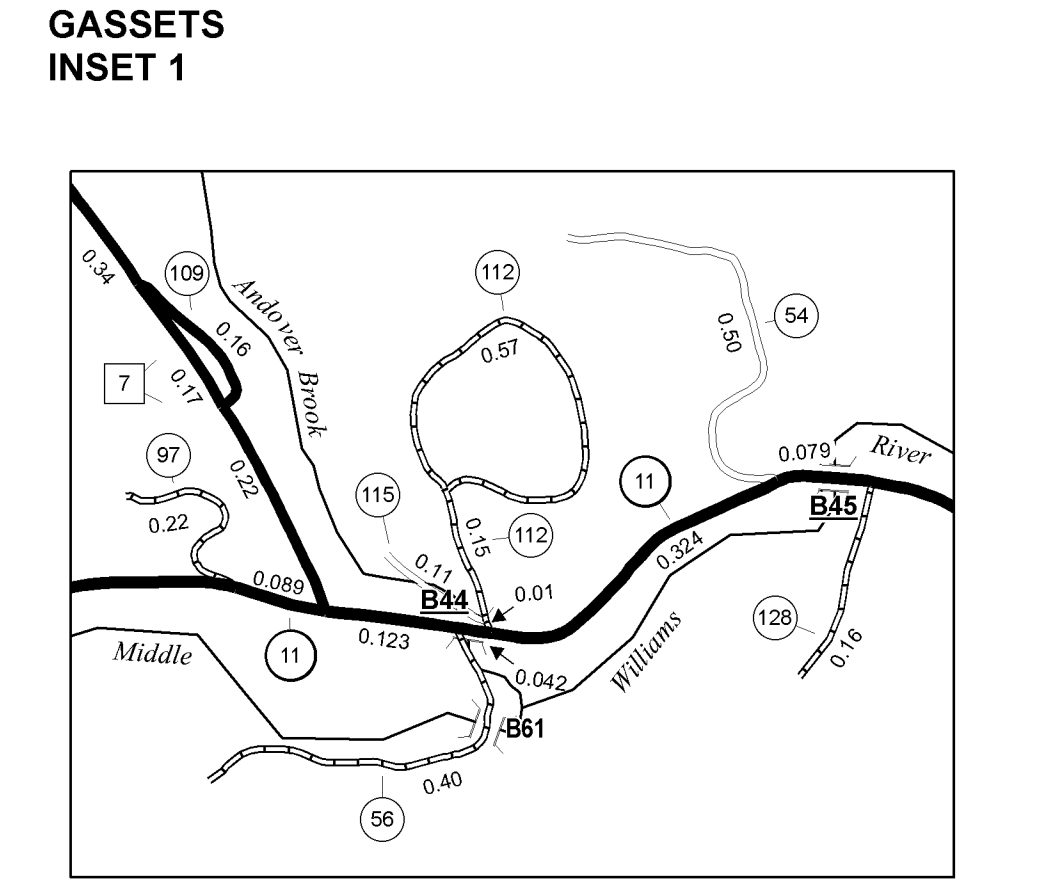
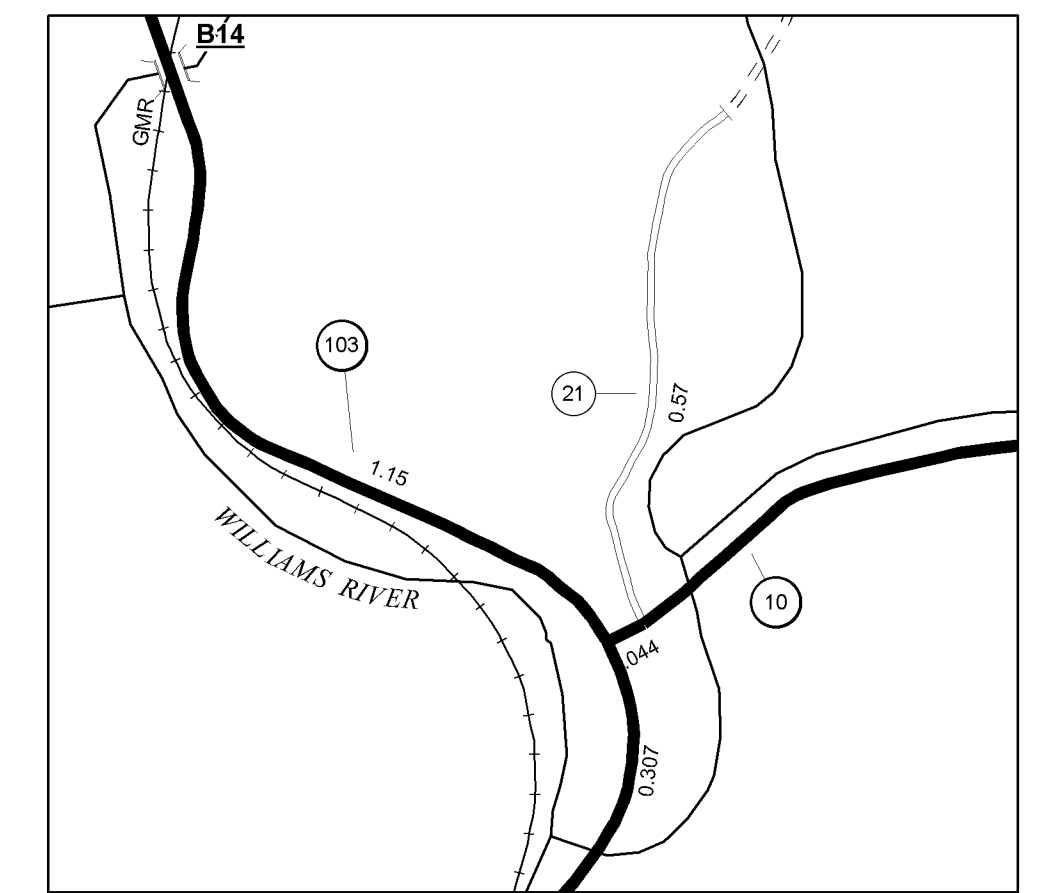
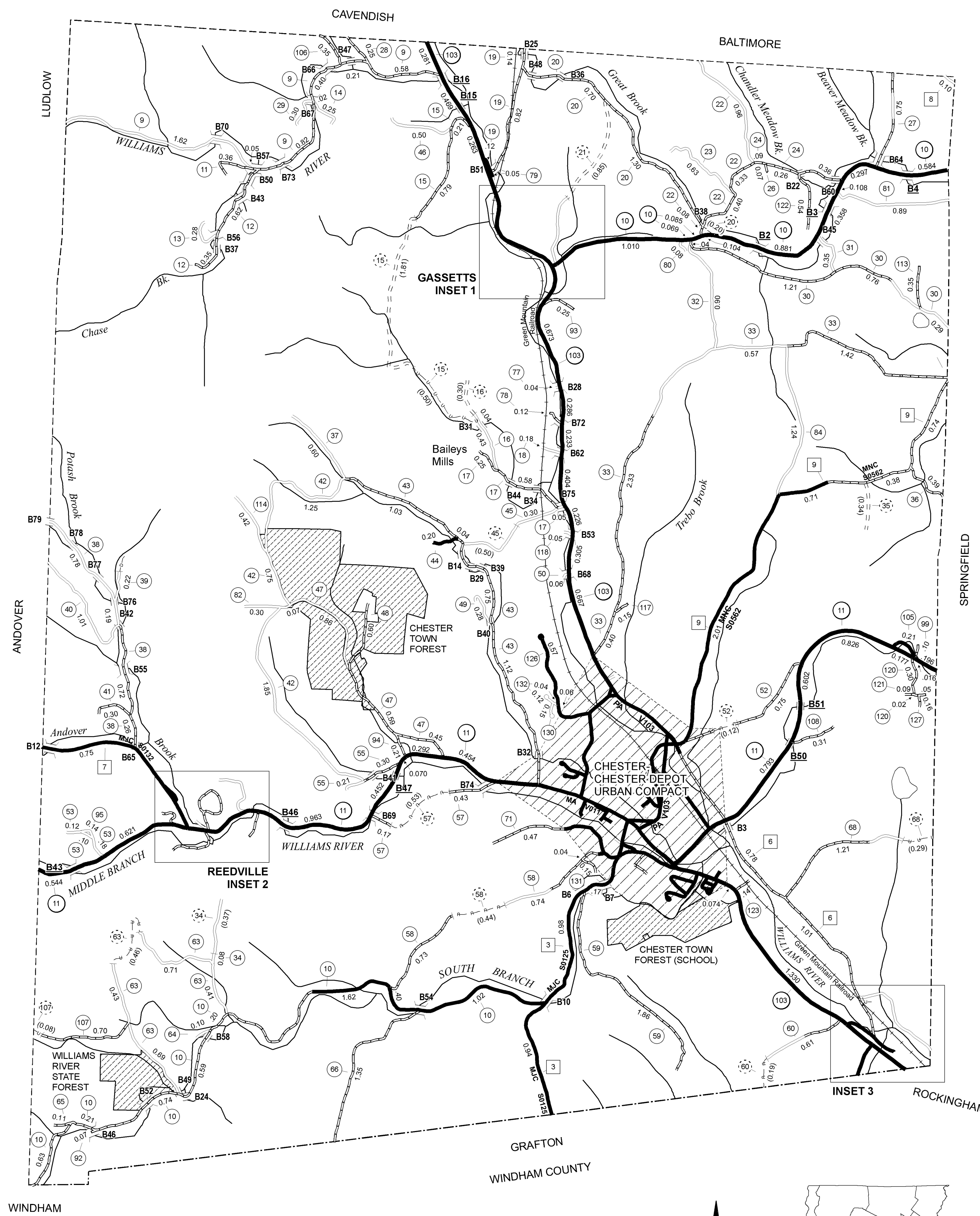

SCALE FOR INSETS (UNLESS OTHERWISE NOTED)

VERMONT
GENERAL HIGHWAY MAP
Town of Chester
WINDSOR COUNTY
Transportation District #2

Prepared by the
Vermont Agency of Transportation
Policy & Planning Division
in cooperation with
U.S. Department of Transportation
Federal Highway Administration

Mileage as of: Feb. 10, 2005
Map generated: December, 2005

